

4

3

2

1

NOTES:

- 1. MATERIALS OF CONSTRUCTION
 - 1. VESSEL AND PIPING: CARBON STEEL
 - 2. JACKET: STAINLESS STEEL AND PAINTED STEEL
- 2. PRESSURE VESSEL BUILT IN ACCORDANCE WITH ASME SECTION IV AND CARRIES AN "H" STAMP
- 3. MAXIMUM ALLOWABLE WORKING PRESSURE UP TO 150PSI
- 4. BOILER IS UL LISTED TO STANDARD 834
- 5. FOR EW132G - EW216G WITH 480 VOLTS
- 6. BACNET IP AND MSTP, MODBUS RS485, AND 4-20 mA REMOTE SET POINT STANDARD
- 7. REFER TO THE INSTALLATION AND OPERATION MANUAL FOR MORE INFORMATION

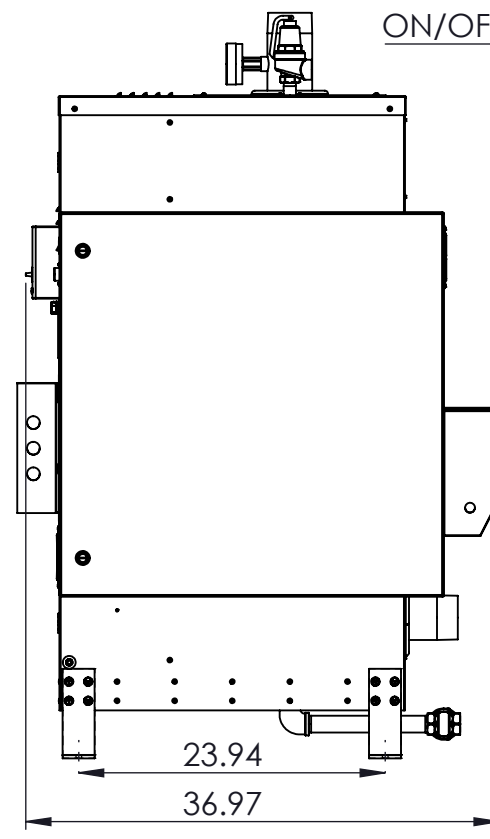
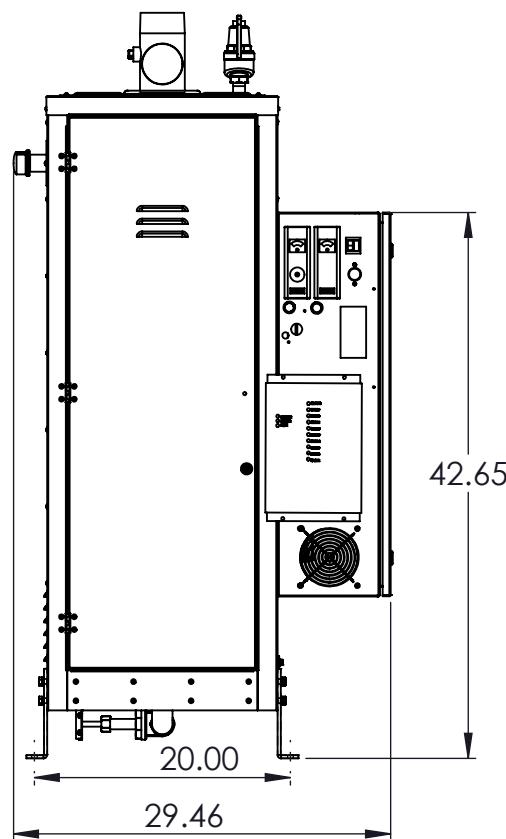
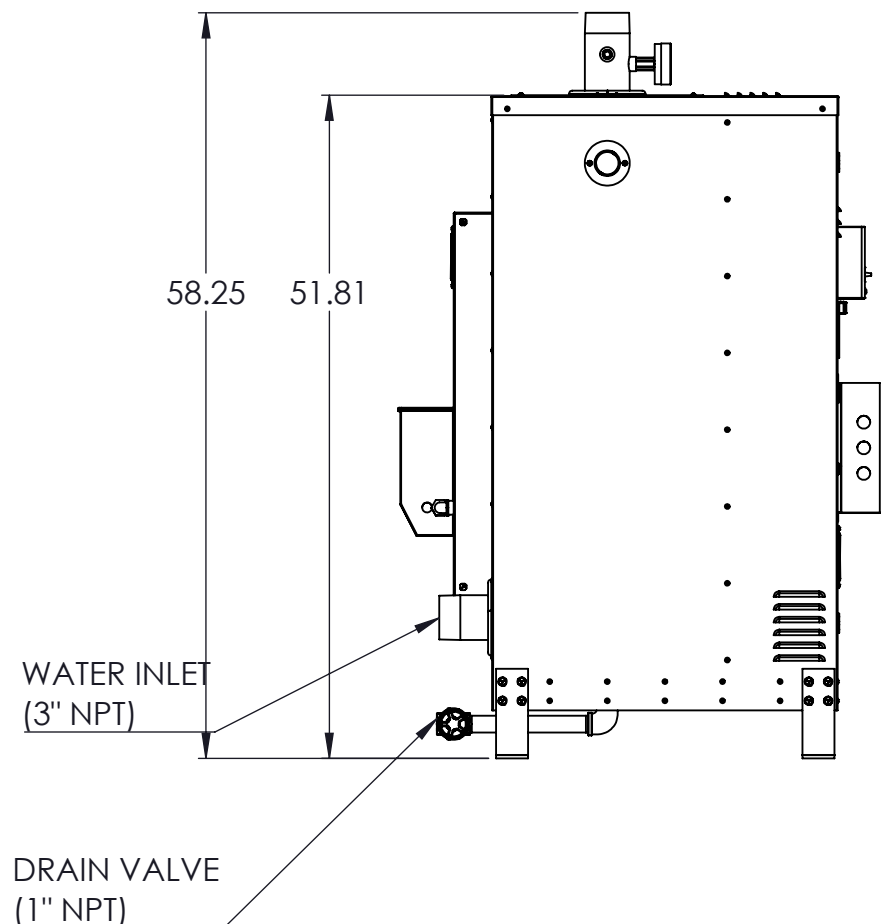
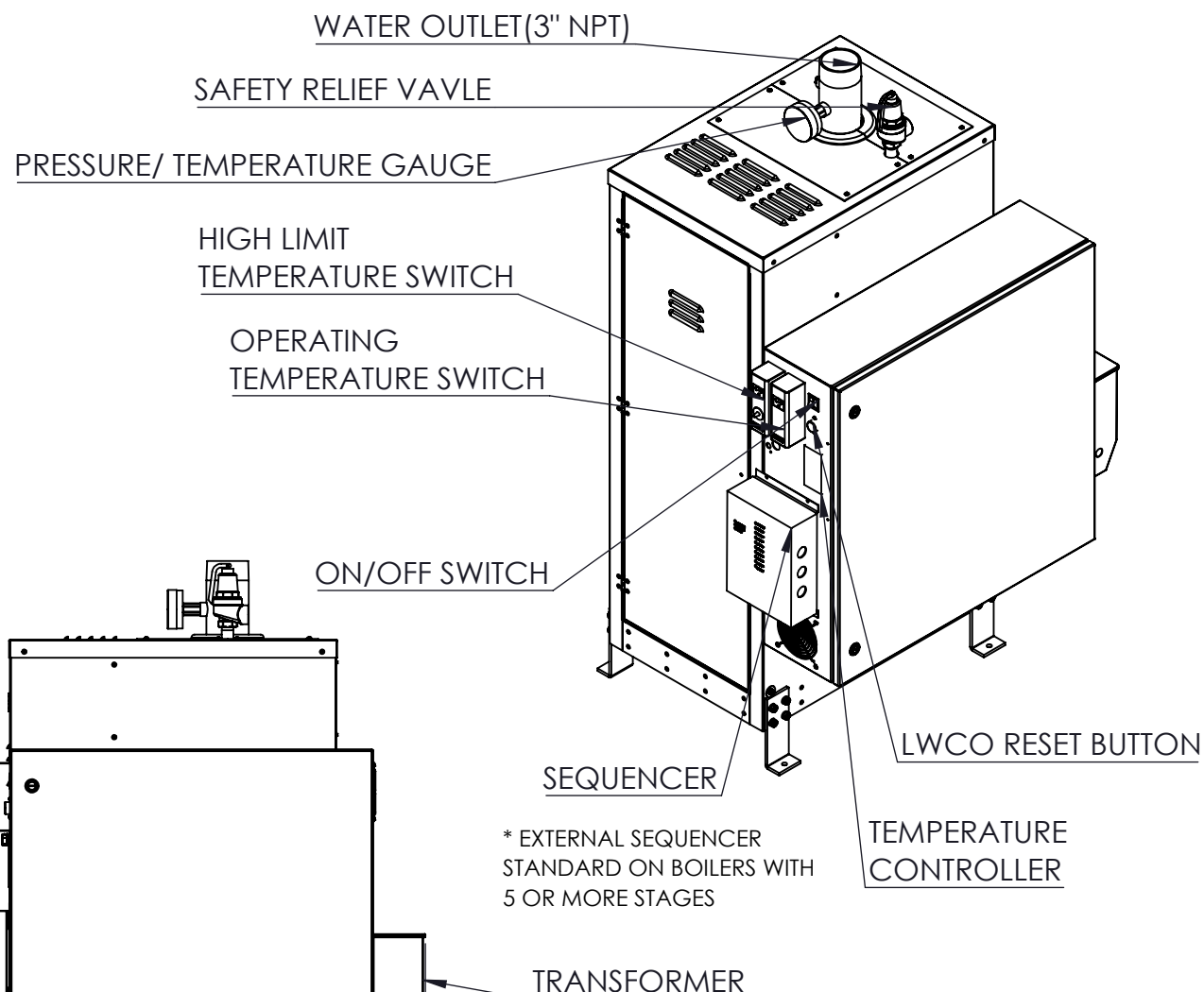
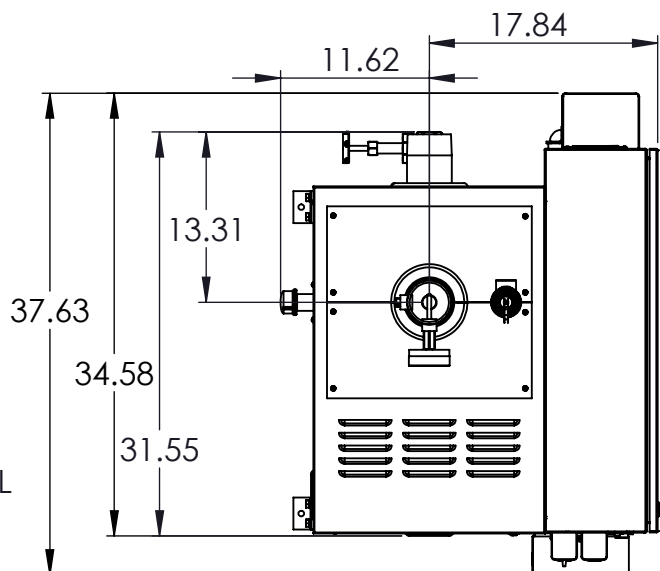

* EXTERNAL SEQUENCER STANDARD ON BOILERS WITH 5 OR MORE STAGES

UNIT WITH 480V	NUMBER OF STAGES
EW132G 132kW	4
EW144G 144kW	4
EW162G 162kW	4
EW180G 180kW	4
EW198G 198kW	5
EW216G 216kW	5

DIMENSIONS ARE SHOWN IN INCHES (CENTIMETERS) TOLERANCES ARE AS FOLLOWS UNLESS OTHERWISE SPECIFIED
 X.XX X.XXX X.XXXX ANGULAR FINISH
 ±.12 ±.031 ±.0156 ±1.0° 250
 REMOVE AND DEBURR SHARP EDGES AND CORNERS
 ALL DIMENSIONS ARE AFTER FINISH OR PLATING
 REFERENCE DIMENSIONS ARE SHOWN IN PARENTHESES ()
 CRITICAL DIMENSIONS ARE SHOWN IN

THIS DRAWING AND/OR SPECIFICATIONS ARE THE PROPERTY OF DIVERSIFIED HEAT TRANSFER INC. THIS CONFIDENTIAL AND PROPRIETARY INFORMATION SHALL NOT BE USED, COPIED OR REPRODUCED IN ANY MEANS AS THE BASIS FOR MANUFACTURE OR SALE OF APPARATUS WITHOUT WRITTEN AUTHORIZATION FROM OWNER.



TITLE EW132G-EW216G 480/3 ELECTRIC WATER BOILERS

A/1		INITIAL DRAWING	SC	5/7/24
REV	ECN	REVISION DESCRIPTION	NAME	DATE

THIRD ANGLE PROJECTION	DWG. SCALE	MATERIAL SPEC:
	1:16	

	NAME	DATE	DWG#	REV
DRAWN BY	S	04/29/2024	EW132GF-EW216GF	A/1
CHECKED BY			SHEET 1 OF 2	

4

3

2

1

4

3

2

1

NOTES:

- 1. SERVICE CLEARANCES TO BE IN CONFORMANCE TO NEC REQUIREMENTS. ALLOW A MINIMUM OF 36" CLEARANCE IN FRONT OF DOORS FOR SERVICING OF HEATING ELEMENTS. RECOMMENDED 24" CLEARANCE FOR OTHER SIDES OF BOILER FOR SERVICING.
- 2. MINIMUM 1" CLEARANCE TO ALL COMBUSTIBLE MATERIALS

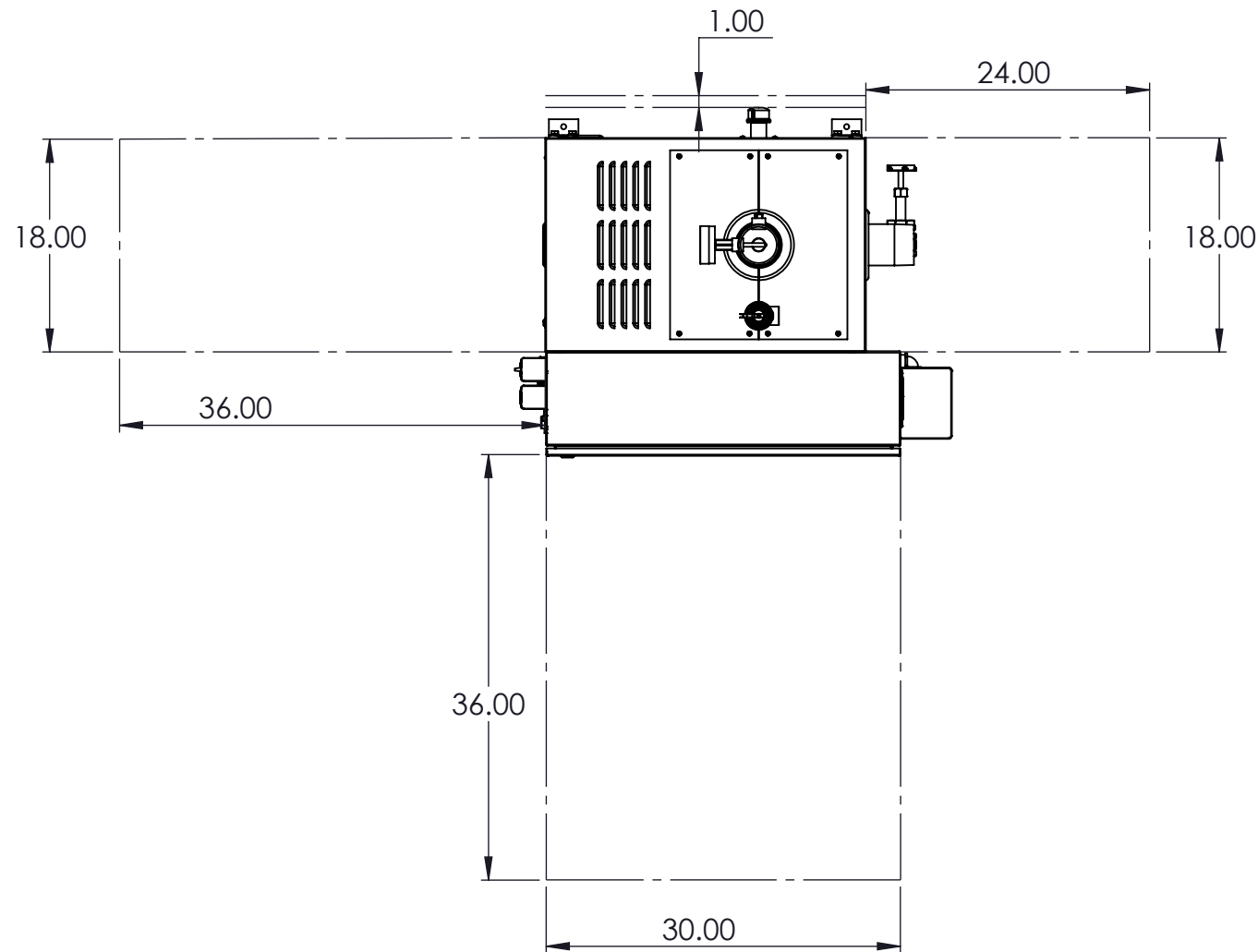

SERVICE CLEARANCES FOR 132G - 180G FOR 480V

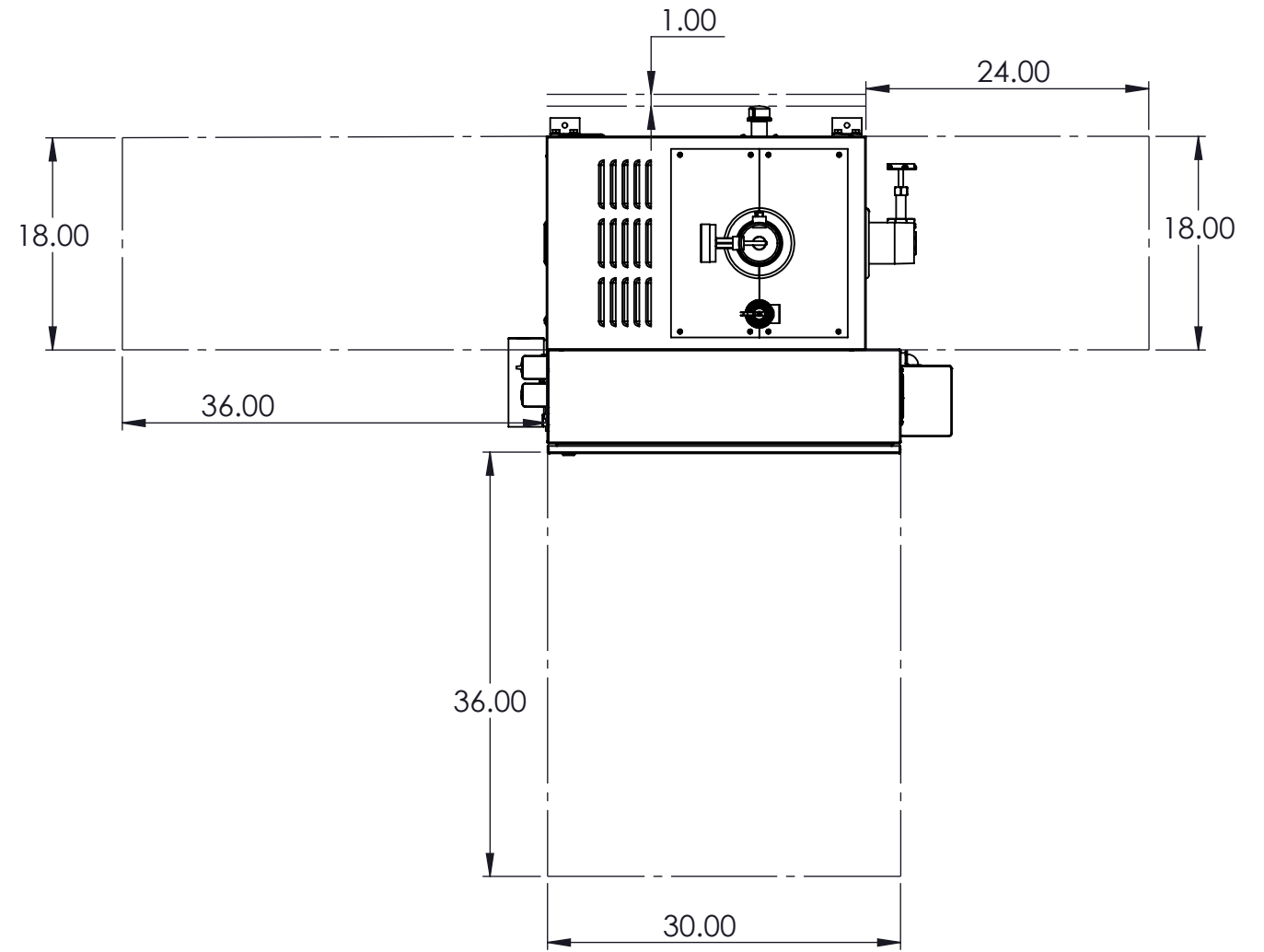

SERVICE CLEARANCES FOR 198G - 225 FOR 480V

DIMENSIONS ARE SHOWN IN INCHES (CENTIMETERS)
 TOLERANCES ARE AS FOLLOWS UNLESS OTHERWISE SPECIFIED
 X.XX X.XXX X.XXXX ANGULAR FINISH
 ±.12 ±.031 ±.0156 ±1.0° 250
 REMOVE AND DEBURR SHARP EDGES AND CORNERS
 ALL DIMENSIONS ARE AFTER FINISH OR PLATING
 REFERENCE DIMENSIONS ARE SHOWN IN PARENTHESES ()
 CRITICAL DIMENSIONS ARE SHOWN IN

THIS DRAWING AND/OR SPECIFICATIONS ARE THE PROPERTY OF DIVERSIFIED HEAT TRANSFER INC. THIS CONFIDENTIAL AND PROPRIETARY INFORMATION SHALL NOT BE USED, COPIED OR REPRODUCED IN ANY MEANS AS THE BASIS FOR MANUFACTURE OR SALE OF APPARATUS WITHOUT WRITTEN AUTHORIZATION FROM OWNER.



439 MAIN RD. TOWACO NJ 07082
 PHONE: (800) 221-1522 FAX: (718) 386-7809

TITLE
 EW132G-EW216G 480/3 ELECTRIC WATER BOILERS

A/1		INITIAL DRAWING	SC	5/7/24
REV	ECN	REVISION DESCRIPTION	NAME	DATE

THIRD ANGLE PROJECTION	DWG. SCALE	MATERIAL SPEC:	NAME	DATE	DWG#	REV
	1:16		S	04/29/2024	EW132GF-EW216GF	A/1
			CHECKED BY		SHEET 2 OF 2	

4

3

2

1

4

3

2

1

NOTES:

- 1. MATERIALS OF CONSTRUCTION
 - 1. VESSEL AND PIPING: CARBON STEEL
 - 2. JACKET: STAINLESS STEEL AND PAINTED STEEL
- 2. PRESSURE VESSEL BUILT IN ACCORDANCE WITH ASME SECTION IV AND CARRIES AN "H" STAMP
- 3. MAXIMUM ALLOWABLE WORKING PRESSURE UP TO 150PSI
- 4. BOILER IS UL LISTED TO STANDARD 834
- 5. FOR EW132G WITH 208 & 240 VOLTS
- 6. BACNET IP AND MSTP, MODBUS RS485, AND 4-20 mA REMOTE SET POINT STANDARD
- 7. REFER TO THE INSTALLATION AND OPERATION MANUAL FOR MORE INFORMATION

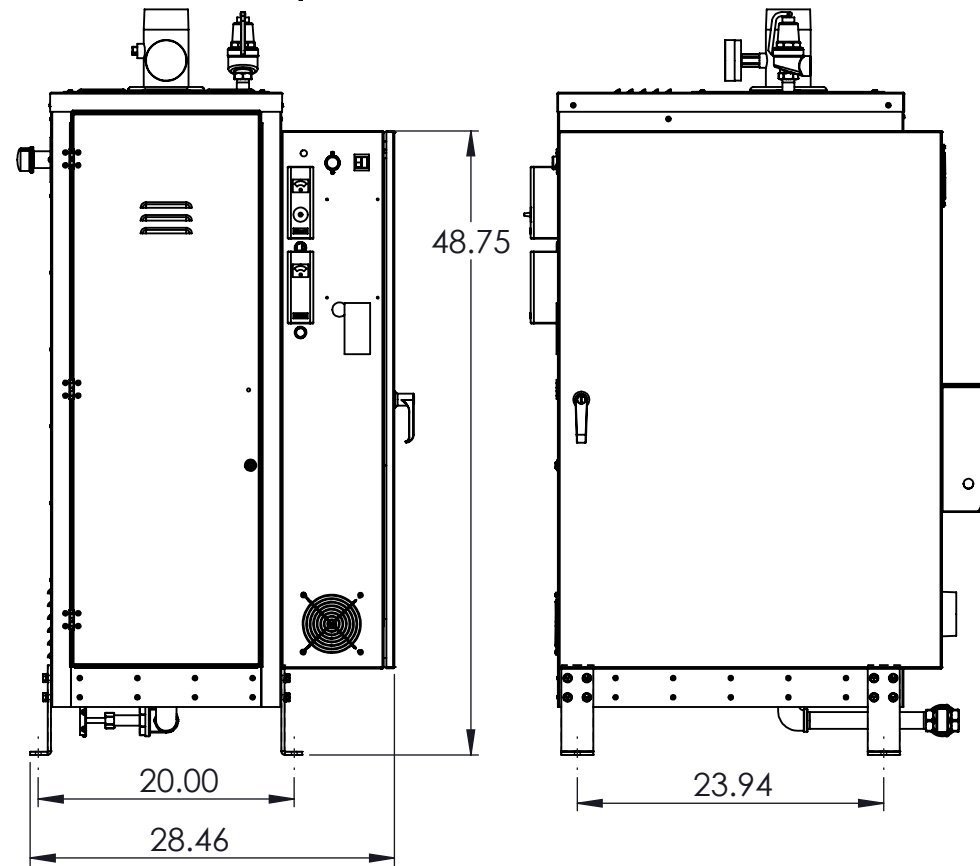
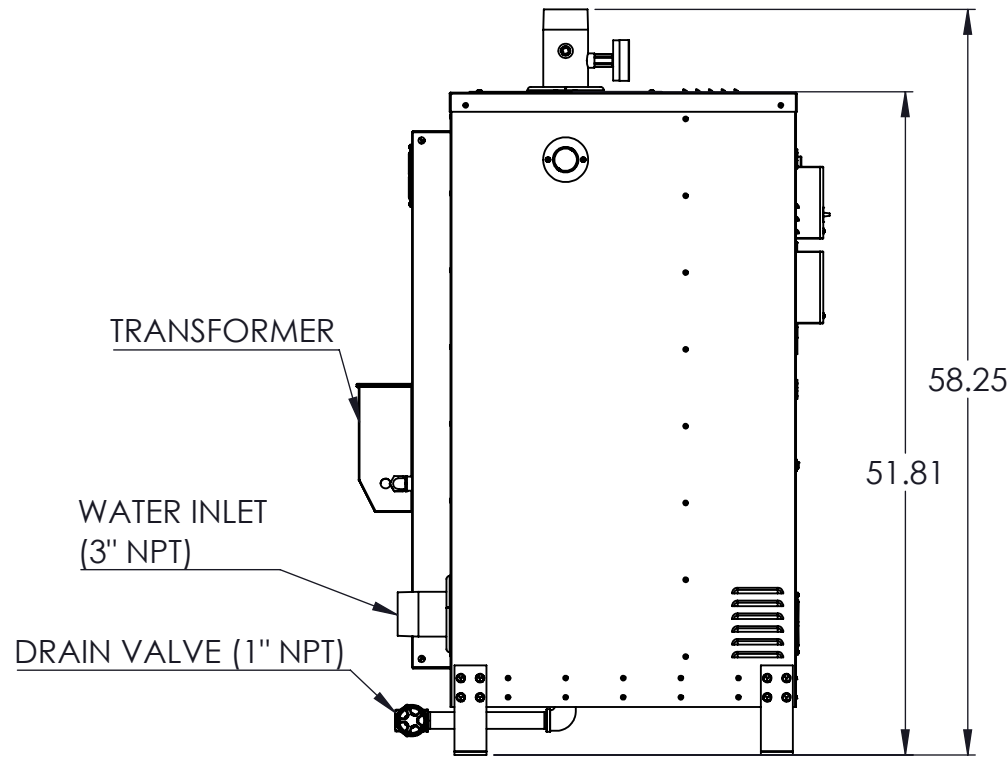
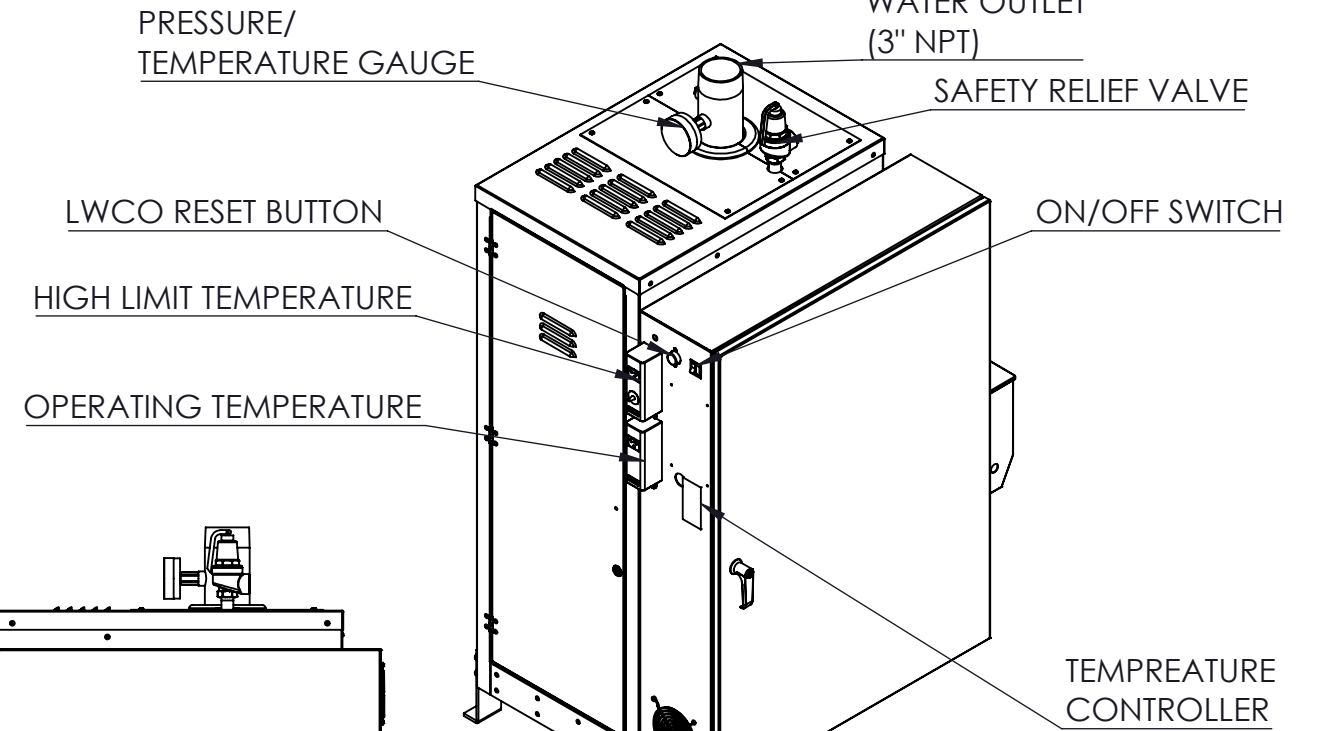
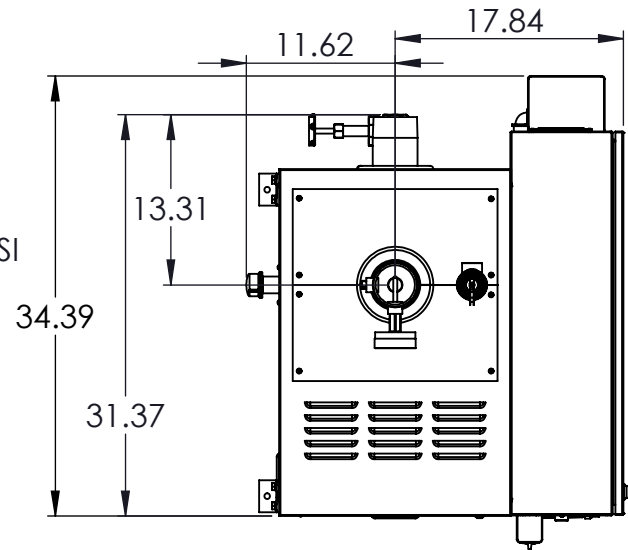

UNITS WITH 208V OR 240V	NUMBER OF STAGES
EW132G 132kW	4

DIMENSIONS ARE SHOWN IN INCHES (CENTIMETERS)
 TOLERANCES ARE AS FOLLOWS UNLESS OTHERWISE SPECIFIED
 X.XX X.XXX X.XXXX ANGULAR FINISH
 ±.12 ±.031 ±.0156 ±1.0° 250
 REMOVE AND DEBURR SHARP EDGES AND CORNERS
 ALL DIMENSIONS ARE AFTER FINISH OR PLATING
 REFERENCE DIMENSIONS ARE SHOWN IN PARENTHESES ()
 CRITICAL DIMENSIONS ARE SHOWN IN

THIS DRAWING AND/OR SPECIFICATIONS ARE THE PROPERTY OF DIVERSIFIED HEAT TRANSFER INC. THIS CONFIDENTIAL AND PROPRIETARY INFORMATION SHALL NOT BE USED, COPIED OR REPRODUCED IN ANY MEANS AS THE BASIS FOR MANUFACTURE OR SALE OF APPARATUS WITHOUT WRITTEN AUTHORIZATION FROM OWNER.

SUSSMAN
 ELECTRIC BOILERS
 439 MAIN RD. TOWACO NJ 07082
 PHONE: (800) 221-1522 FAX: (718) 386-7809

TITLE EW132G 208/3, 240/3 ELECTRIC WATER BOILERS

A/1		INITIAL DRAWING	SC	5/1/24
REV	ECN	REVISION DESCRIPTION	NAME	DATE

THIRD ANGLE PROJECTION	DWG. SCALE	MATERIAL SPEC:	NAME	DATE	DWG#	REV
	1:16		S	05/01/2024	EW132GBC	A/1
			CHECKED BY		SHEET 1 OF 2	

4

3

2

1

4

3

2

1

NOTES:

- 1. SERVICE CLEARANCES TO BE IN CONFORMANCE TO NEC REQUIREMENTS. ALLOW A MINIMUM OF 36" CLEARANCE IN FRONT OF DOORS FOR SERVICING OF HEATING ELEMENTS. RECOMMENDED 24" CLEARANCE FOR OTHER SIDES OF BOILER FOR SERVICING.
- 2. MINIMUM 1" CLEARANCE TO ALL COMBUSTIBLE MATERIALS

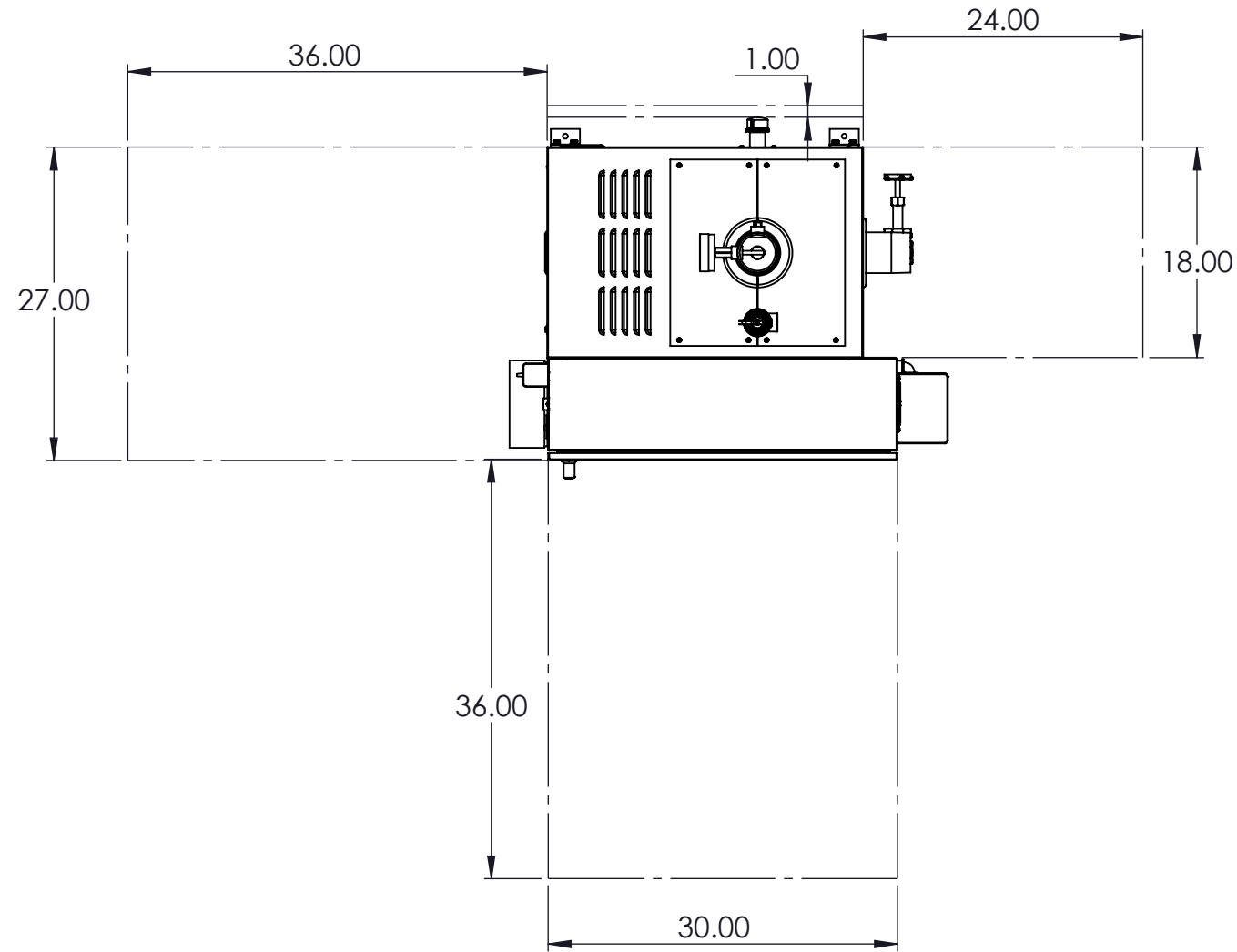

DIMENSIONS ARE SHOWN IN INCHES (CENTIMETERS)
 TOLERANCES ARE AS FOLLOWS UNLESS OTHERWISE SPECIFIED
 X.XX X.XXX X.XXXX ANGULAR FINISH
 ±.12 ±.031 ±.0156 ±1.0° 250
 REMOVE AND DEBURR SHARP EDGES AND CORNERS
 ALL DIMENSIONS ARE AFTER FINISH OR PLATING
 REFERENCE DIMENSIONS ARE SHOWN IN PARENTHESES ()
 CRITICAL DIMENSIONS ARE SHOWN IN

THIS DRAWING AND/OR SPECIFICATIONS ARE THE PROPERTY OF DIVERSIFIED HEAT TRANSFER INC. THIS CONFIDENTIAL AND PROPRIETARY INFORMATION SHALL NOT BE USED, COPIED OR REPRODUCED IN ANY MEANS AS THE BASIS FOR MANUFACTURE OR SALE OF APPARATUS WITHOUT WRITTEN AUTHORIZATION FROM OWNER.



439 MAIN RD. TOWACO NJ 07082
 PHONE: (800) 221-1522 FAX: (718) 386-7809

TITLE
 EW132G 208/3, 240/3 ELECTRIC
 WATER BOILERS

A/1		INITIAL DRAWING	SC	5/1/24
REV	ECN	REVISION DESCRIPTION	NAME	DATE

THIRD ANGLE PROJECTION 	DWG. SCALE 1:16	MATERIAL SPEC:	NAME	DATE	DWG#	REV
			S	05/01/2024	EW132GBC	A/1
			CHECKED BY		SHEET 2 OF 2	

4

3

2

1

4

3

2

1

NOTES:

- 1. MATERIALS OF CONSTRUCTION
 - 1. VESSEL AND PIPING: CARBON STEEL
 - 2. JACKET: STAINLESS STEEL AND PAINTED STEEL
- 2. PRESSURE VESSEL BUILT IN ACCORDANCE WITH ASME SECTION IV AND CARRIES AN "H" STAMP
- 3. MAXIMUM ALLOWABLE WORKING PRESSURE UP TO 150PSI
- 4. BOILER IS UL LISTED TO STANDARD 834
- 5. FOR EW144G-EW216G FOR VOLTAGES 208, 240 VOLTS
- 6. BACNET IP AND MSTP, MODBUS RS485, AND 4-20 mA REMOTE SET POINT STANDARD
- 7. REFER TO THE INSTALLATION AND OPERATION MANUAL FOR MORE INFORMATION

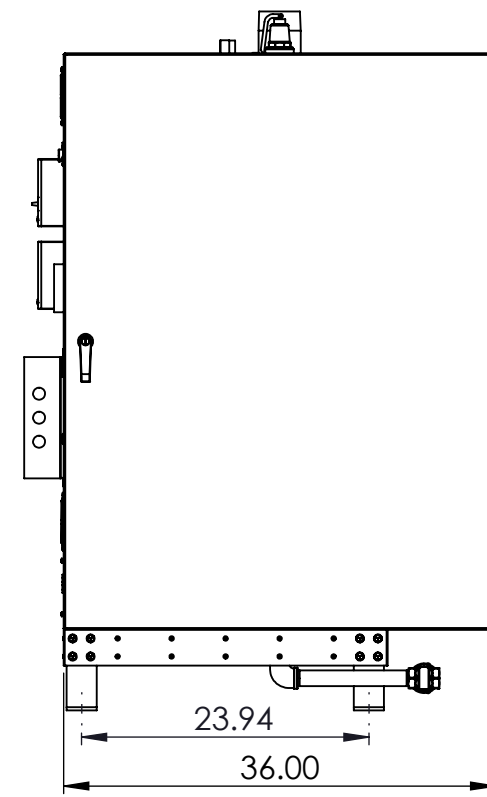
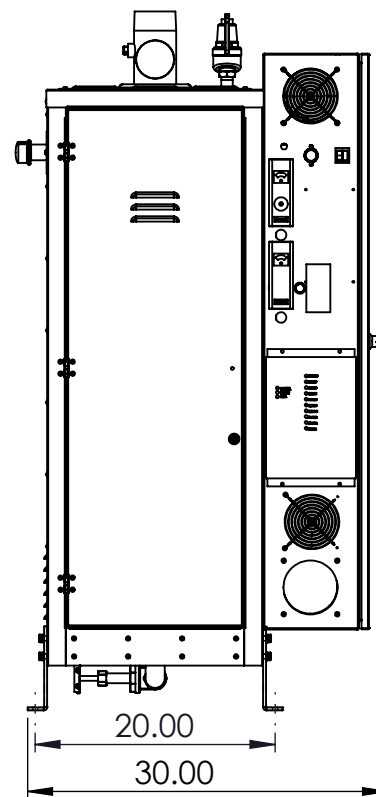
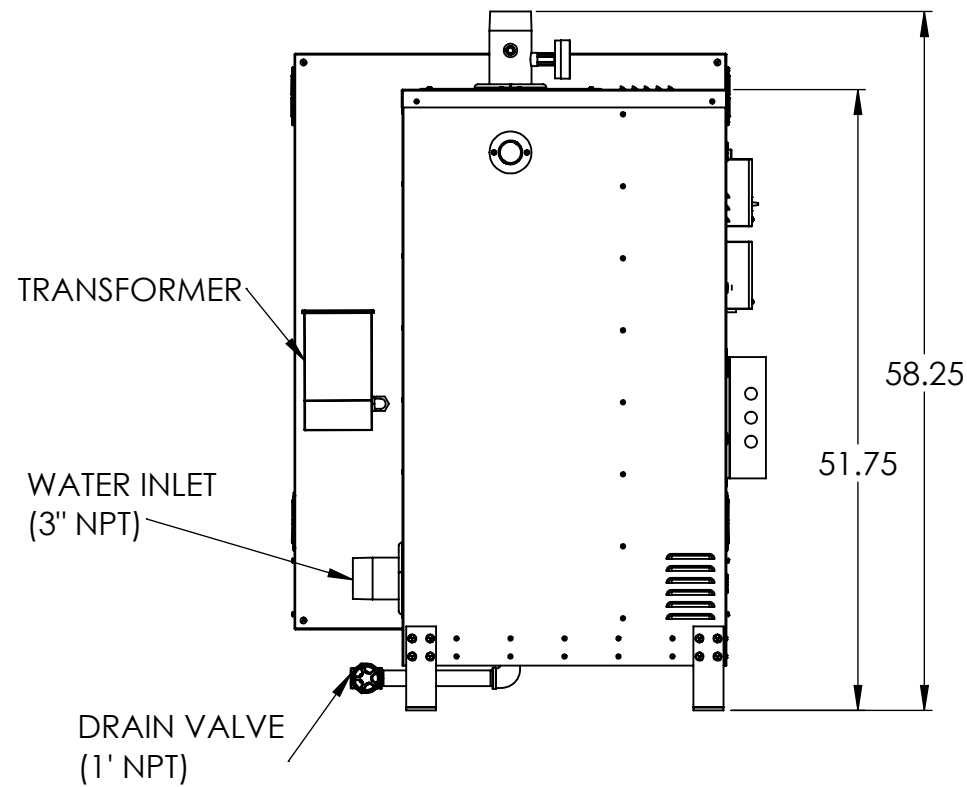
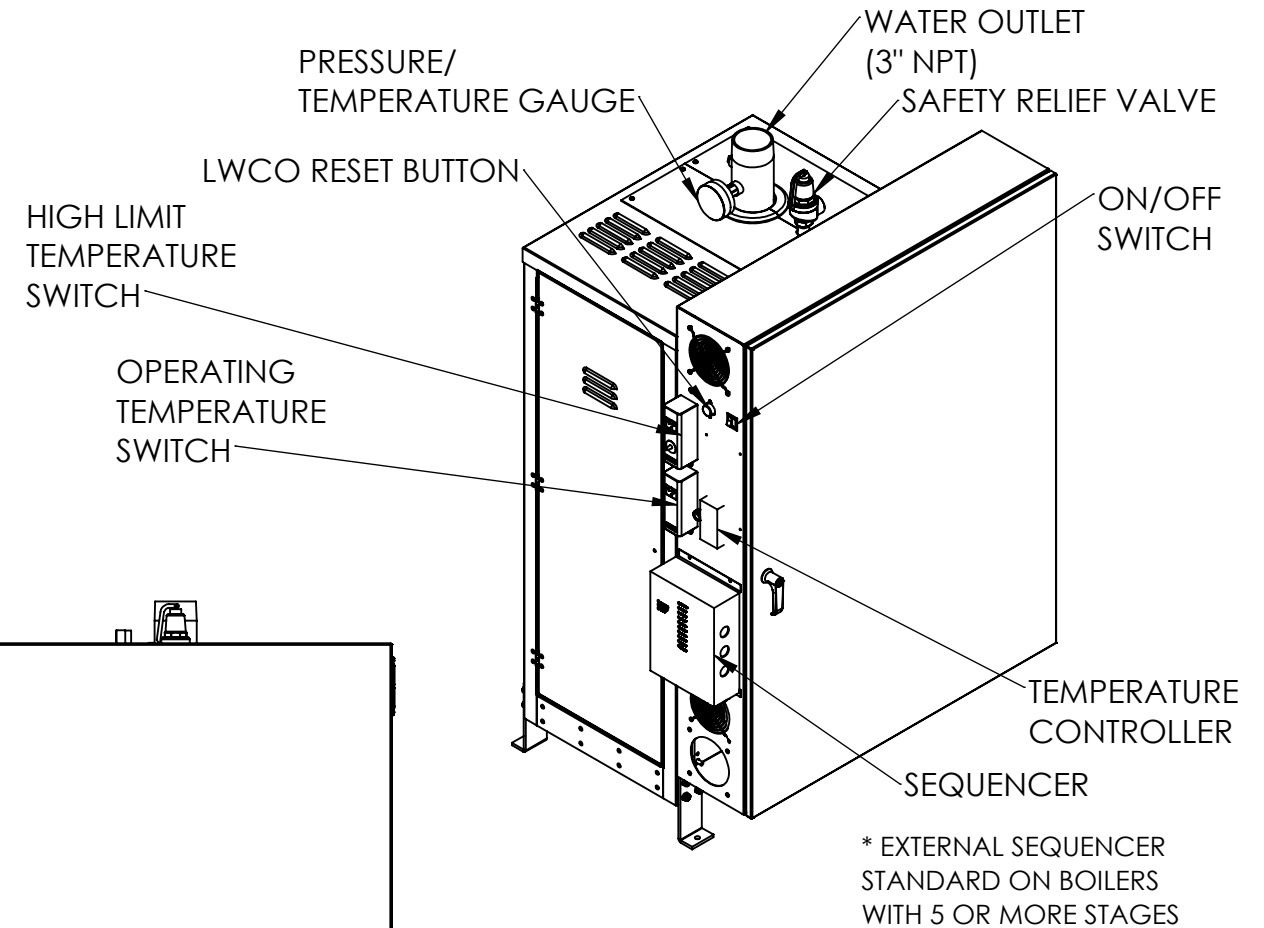
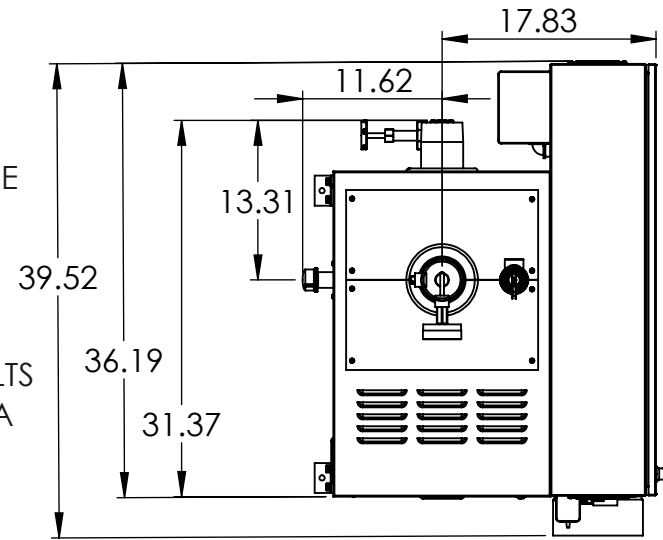

UNIT WITH 208V OR 240V	NUMBER OF STAGES
EW144G 144kW	4
EW162G 162kW	4
EW180G 180kW	4
EW198G 198kW	6
EW216G 216kW	6

* EXTERNAL SEQUENCER STANDARD ON BOILERS WITH 5 OR MORE STAGES

DIMENSIONS ARE SHOWN IN INCHES [CENTIMETERS]
 TOLERANCES ARE AS FOLLOWS UNLESS OTHERWISE SPECIFIED
 X.XX X.XXX X.XXXX ANGULAR FINISH
 ±.12 ±.031 ±.0156 ±1.0° 250
 REMOVE AND DEBURR SHARP EDGES AND CORNERS
 ALL DIMENSIONS ARE AFTER FINISH OR PLATING
 REFERENCE DIMENSIONS ARE SHOWN IN PARENTHESES ()
 CRITICAL DIMENSIONS ARE SHOWN IN ◯

THIS DRAWING AND/OR SPECIFICATIONS ARE THE PROPERTY OF DIVERSIFIED HEAT TRANSFER INC. THIS CONFIDENTIAL AND PROPRIETARY INFORMATION SHALL NOT BE USED, COPIED OR REPRODUCED IN ANY MEANS AS THE BASIS FOR MANUFACTURE OR SALE OF APPARATUS WITHOUT WRITTEN AUTHORIZATION FROM OWNER.

SUSSMAN
 ELECTRIC BOILERS
 439 MAIN RD. TOWACO NJ 07082
 PHONE: (800) 221-1522 FAX: (718) 386-7809

TITLE
 EW144G-EW216G 208/3, 240/3
 ELECTRIC WATER BOILERS

A/1		INITIAL DRAWING	JH	5/10/24
REV	ECN	REVISION DESCRIPTION	NAME	DATE

THIRD ANGLE PROJECTION	DWG. SCALE	MATERIAL SPEC:	NAME	DATE	DWG#	REV
	1:16		JH	05/10/2024	EW144GBC-EW216GBC	A/1
			CHECKED BY		SHEET 1 OF 2	

4

3

2

1

B

B

A

A

4

3

2

1

NOTES:

- 1. SERVICE CLEARANCES TO BE IN CONFORMANCE TO NEC REQUIREMENTS. ALLOW A MINIMUM OF 36" CLEARANCE IN FRONT OF DOORS FOR SERVICING OF HEATING ELEMENTS. RECOMMENDED 24" CLEARANCE FOR OTHER SIDES OF BOILER FOR SERVICING.
- 2. MINIMUM 1" CLEARANCE TO ALL COMBUSTIBLE MATERIALS

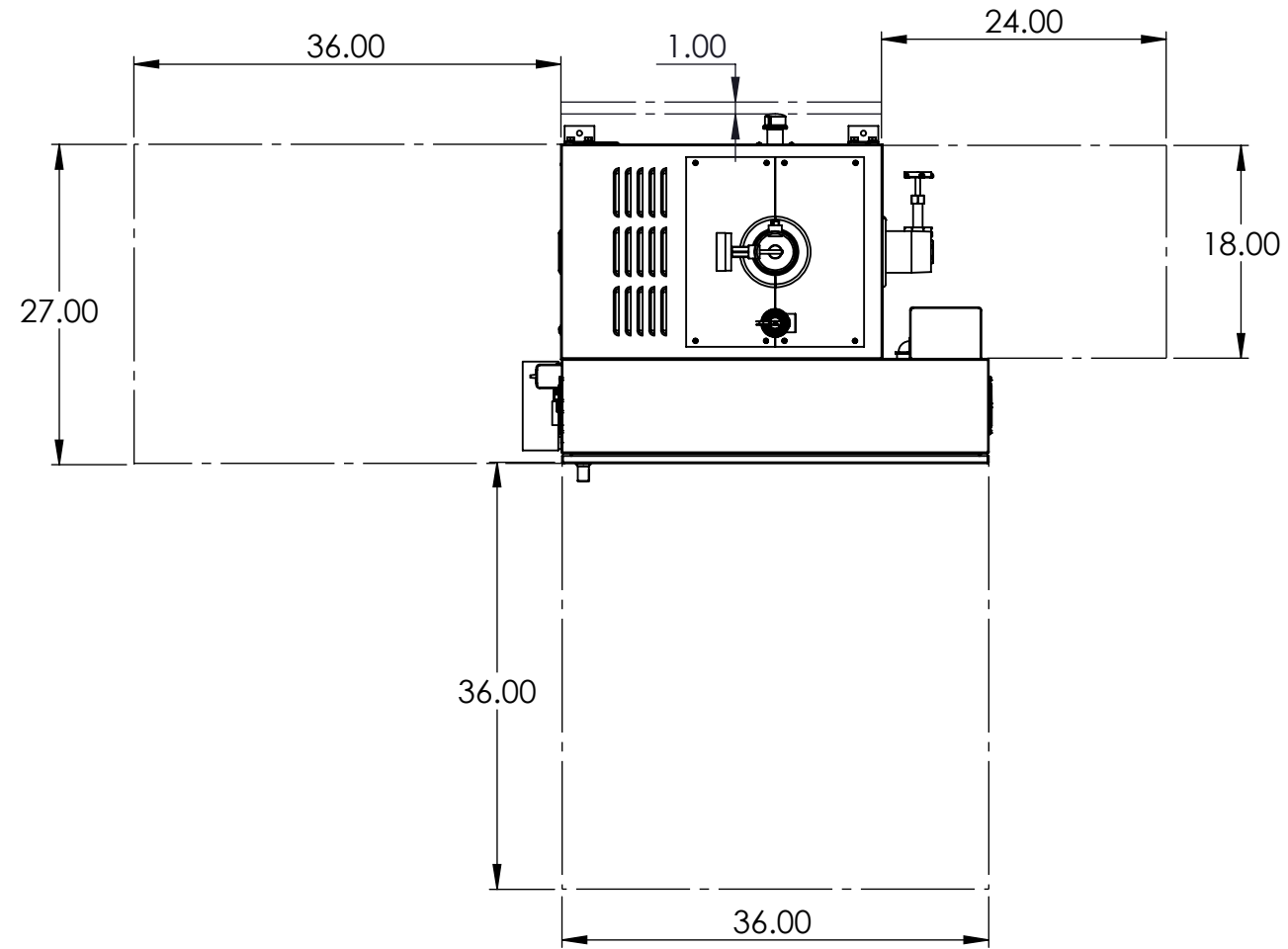

DIMENSIONS ARE SHOWN IN INCHES (CENTIMETERS)
 TOLERANCES ARE AS FOLLOWS UNLESS OTHERWISE SPECIFIED
 X.XX X.XXX X.XXXX ANGULAR FINISH
 ±.12 ±.031 ±.0156 ±1.0° 250
 REMOVE AND DEBURR SHARP EDGES AND CORNERS
 ALL DIMENSIONS ARE AFTER FINISH OR PLATING
 REFERENCE DIMENSIONS ARE SHOWN IN PARENTHESES ()
 CRITICAL DIMENSIONS ARE SHOWN IN

THIS DRAWING AND/OR SPECIFICATIONS ARE THE PROPERTY OF DIVERSIFIED HEAT TRANSFER INC. THIS CONFIDENTIAL AND PROPRIETARY INFORMATION SHALL NOT BE USED, COPIED OR REPRODUCED IN ANY MEANS AS THE BASIS FOR MANUFACTURE OR SALE OF APPARATUS WITHOUT WRITTEN AUTHORIZATION FROM OWNER.

SUSSMAN
 ELECTRIC BOILERS
 439 MAIN RD. TOWACO NJ 07082
 PHONE: (800) 221-1522 FAX: (718) 386-7809

TITLE EW144G-EW216G 208/3, 240/3
 ELECTRIC WATER BOILERS

A/1		INITIAL DRAWING	JH	5/10/24
REV	ECN	REVISION DESCRIPTION	NAME	DATE

THIRD ANGLE PROJECTION	DWG. SCALE	MATERIAL SPEC:	NAME	DATE	DWG#	REV
	1:16		JH	05/10/2024	EW144GBC-EW216GBC	A/1
			CHECKED BY		SHEET 2 OF 2	

4

3

2

1